

# CARGO HOLD 1

HEIGHT (FROM TANK TOP TILL MAIN DECK ) ABOUT 10.3 MTRS

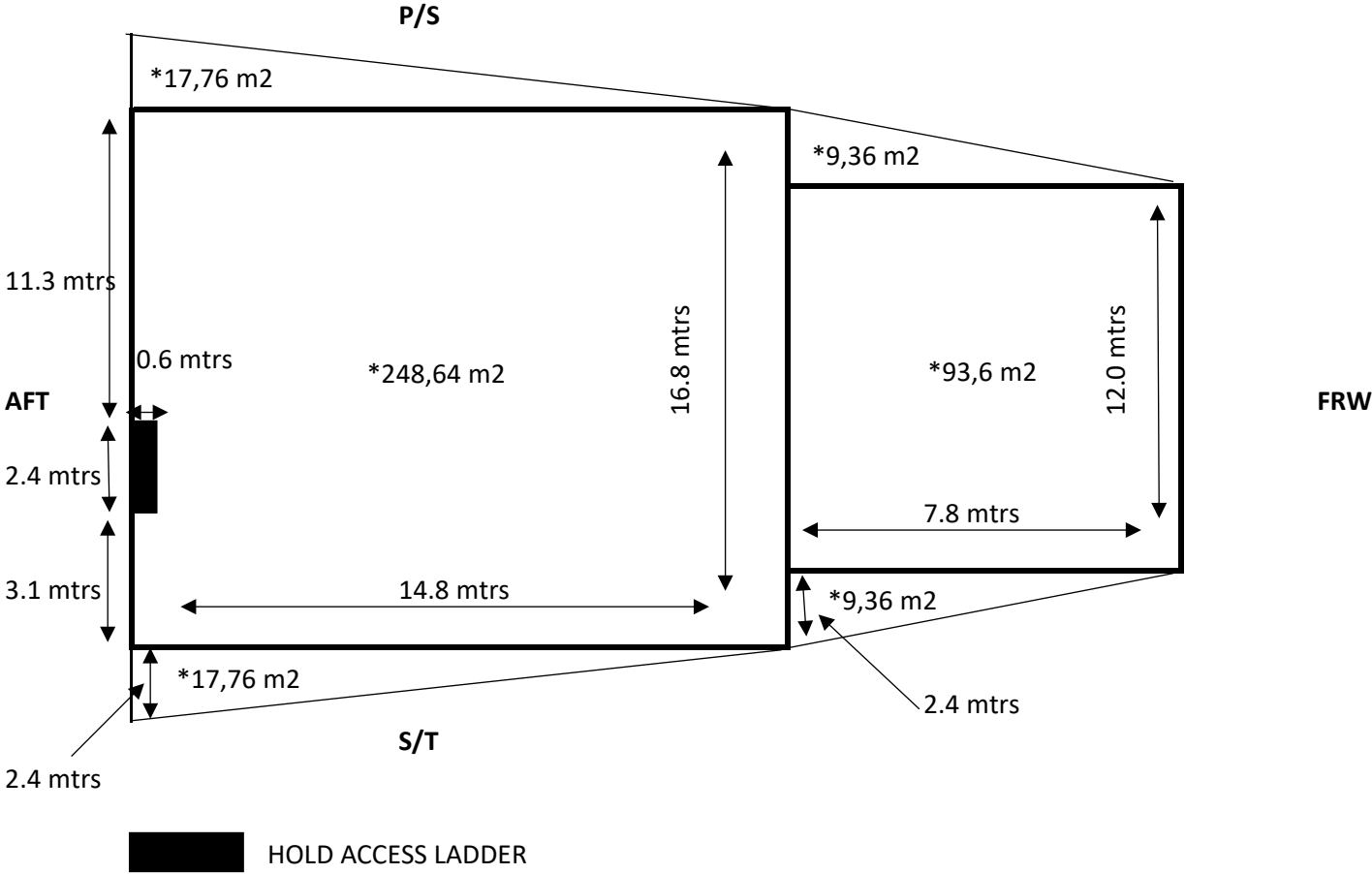

**\* TOTAL m2 : 396,48 m2**

# CARGO HOLD 2

HEIGHT (FROM TANK TOP TILL MAIN DECK ) ABOUT 10.3 MTRS

P/S



S/T

 HOLD ACCESS LADDER

# CARGO HOLD 3

HEIGHT (FROM TANK TOP TILL MAIN DECK ) ABOUT 10.3 MTRS

P/S

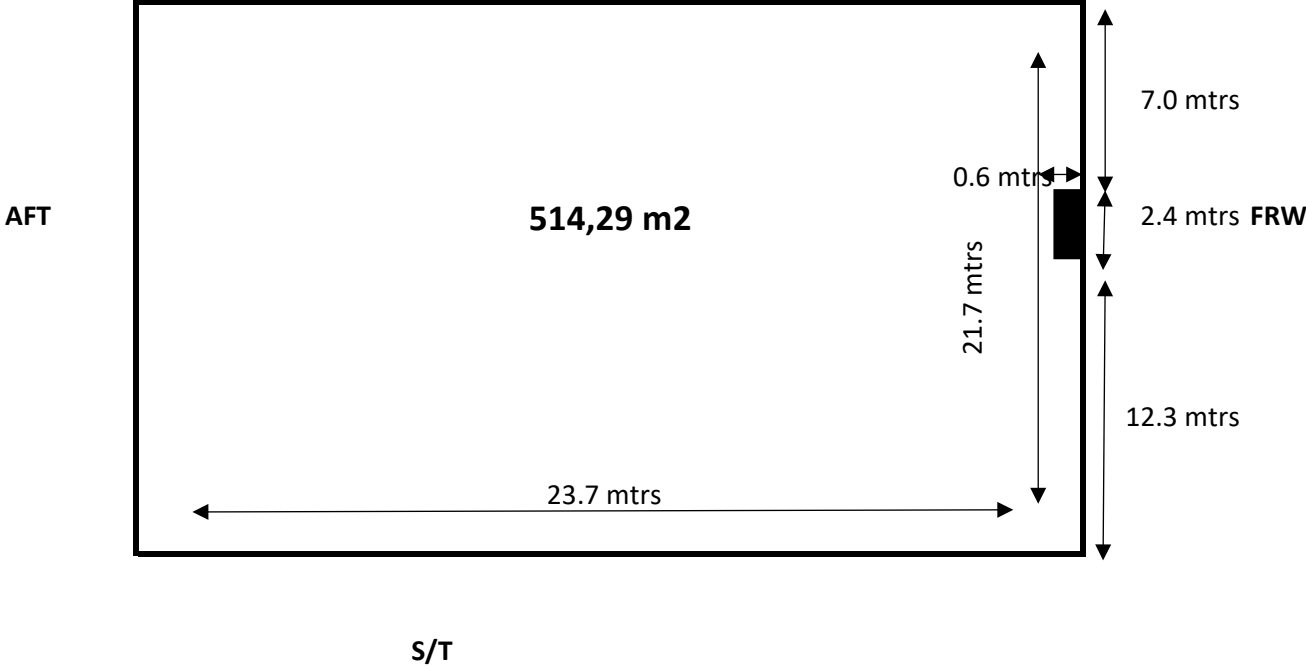

 HOLD ACCESS LADDER

# CARGO HOLD 4

HEIGHT (FROM TANK TOP TILL MAIN DECK ) ABOUT 10.3 MTRS

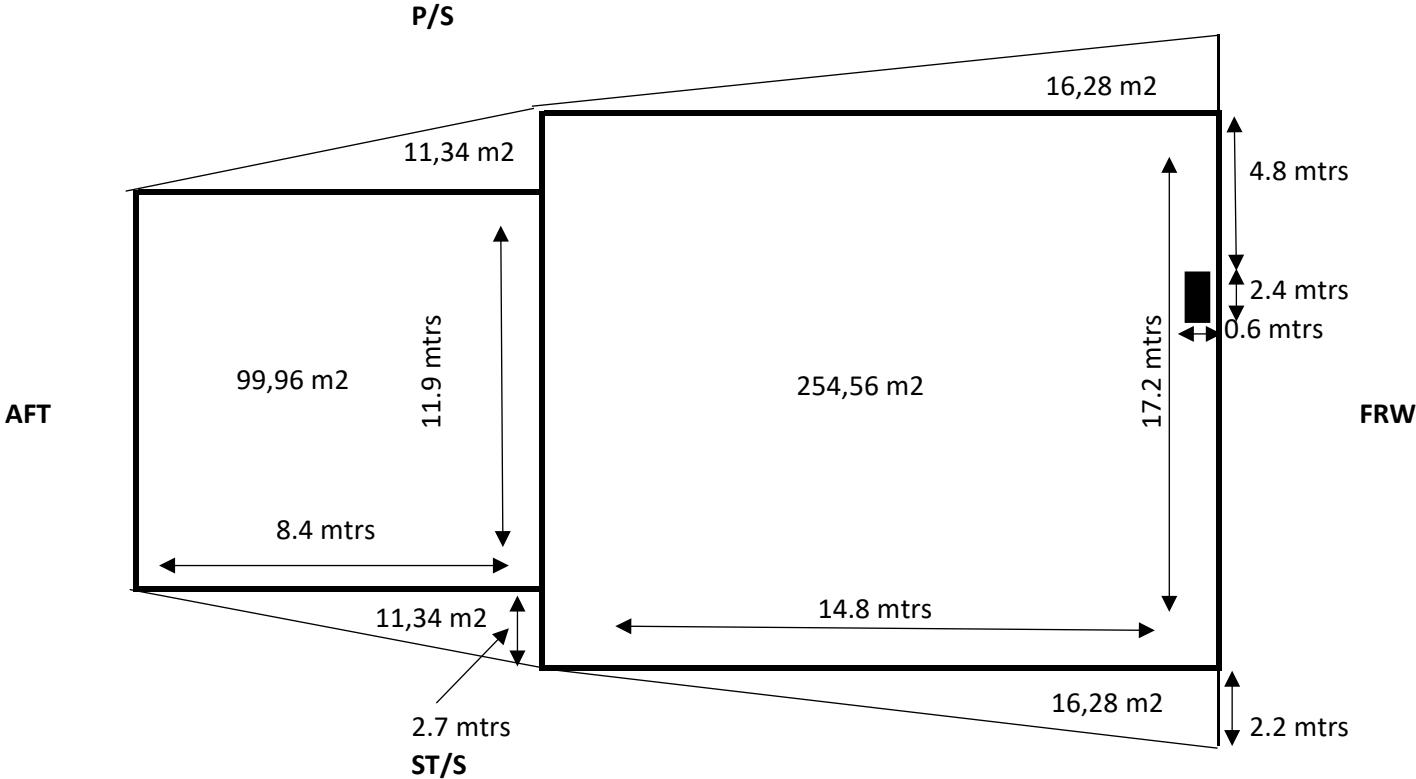

 HOLD ACCESS LADDER

**\* TOTAL m2 : 429,76 m2**